

LIVING & CO[®]

Bar Refrigerator

Model HS-160RN

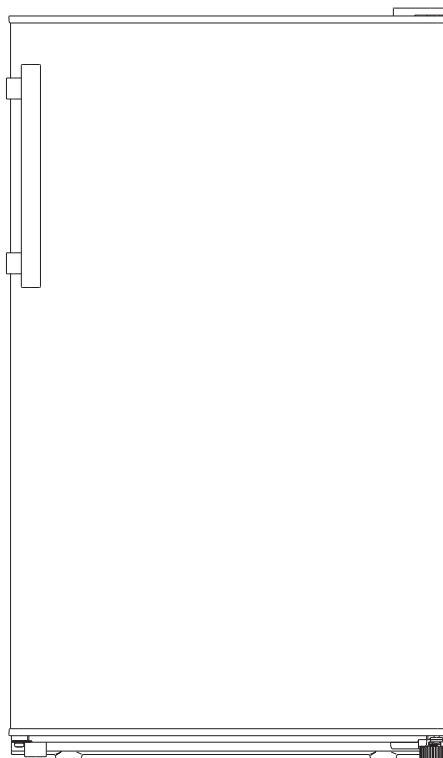

User Manual

AFTER SALES SUPPORT
☎ NZ 0800 422 274

TABLE OF CONTENTS

1. Safety Instructions	P. 3
2. Product Overview	P. 7
3. Getting Started	P. 8
4. Product Use	P. 10
5. Troubleshooting	P. 12
6. Care and Cleaning	P. 14
7. Technical Data	P. 15
8. Notice	P. 15

1. Safety Instructions

IMPORTANT SAFETY INSTRUCTIONS
READ CAREFULLY AND KEEP FOR FUTURE REFERENCE

Read this manual thoroughly before first use, even if you are familiar with this type of product. The safety precautions enclosed herein reduce the risk of fire, electric shock and injury when correctly adhered to. **Keep the manual in a safe place for future reference**, along with the completed warranty card, purchase receipt and carton. If applicable, pass these instructions on to the next owner of the appliance.



Pay particular attention to messages that follow this safety alert symbol or the words **DANGER, WARNING** or **CAUTION**. These words are used to alert you to a potential hazard that can seriously injure you and others. The instructions will tell you how to reduce the risk of injury and let you know what can happen if the instructions are not followed.



WARNING:
Risk of fire

This symbol alerts you to take care as the appliance contains flammable materials: Isobutane as refrigerant and cyclopentane as insulation blowing gas. Do not expose it to high heat, sparks and open flames.

The refrigerant isobutane (R600a) is contained within the refrigerant circuit of the appliance, a gas with a high level of environmental compatibility, which is nevertheless flammable. During transportation and installation of the appliance, ensure that none of the components of the refrigerant circuit become damaged.

WARNING: Never use an appliance with a damaged refrigerant circuit!

If the refrigerant circuit becomes damaged, avoid proximity to open fires and all types of heat and ignition sources. Thoroughly ventilate the room in which the appliance is located.

It is hazardous for anyone other than an authorized service person to service this appliance.

To reduce the risk of fire, electric shock or injury, always follow basic safety precautions and accident prevention measures when using this appliance, including the following:

1.1 Installation

- **Heavy:** This appliance is heavy, take care when moving it. To avoid back or other injury, consider a two person lift or mechanical aid when installing it. Failure to do so can result in back or other injury.
- **Damage:** When unpacking, check the appliance carefully for damage. If it is damaged, do not install the appliance. Contact our customer support centre for advice on examination or return of the damaged appliance.
- **Protect from moisture:** Install the appliance in an indoor area protected from wind, rain, water spray or drips.
- **Protect from heat:** Do not install it next to an oven, grill or other source of high heat, or where it will be exposed to direct sunlight for prolonged periods of time.
- **WARNING:** Ventilation: To ensure proper ventilation, keep any ventilation openings, in the appliance enclosure or in the built-in structure, clear of obstructions. Ensure adequate air circulation around the appliance to prevent overheating.
- **Level:** Install the appliance level in order to ensure proper operation.

1.2 Electrical Safety

- **Voltage:** Plug the appliance in a 220-240V, 50Hz, properly earthed power outlet, which must be in good working order. Make sure your outlet voltage and circuit frequency correspond to the voltage stated on the appliance rating label.
- **Power connection:** Do not use an adaptor; do not use an extension cord. Plug the power plug directly into a power point that cannot easily be turned off accidentally, and that is easily accessible so you can switch it off when required.

- **Power cord:** Do not kink or damage the power supply cord. Do not leave it exposed or dangling. Secure it behind the appliance so no one steps on or places anything on the power supply cord or against it. A squashed or damaged power plug may overheat and cause a fire.
- **Damaged cord:** Do not use a cord that shows cracks or abrasion damage along its length or at either end. Any damage to the cord may cause a short circuit, fire and/or electric shock. If the power cord is damaged, it must be replaced by the manufacturer or its service agent. Contact the customer sales support line for advice.
- **Disconnection:** Never unplug the unit by pulling the cord. Always grip the plug firmly and pull straight out from the power point.
- **Electrical work:** If the installation of this appliance requires any electrical work, make sure it is carried out by a qualified electrician.

1.3 Usage Conditions and Restrictions

- **Indoor domestic use only:** This appliance is intended for indoor domestic use only, which includes use in households, staff kitchen areas in shops, offices, in farm houses and in other working environments, use by clients in hotels, motels, bed and breakfast establishments, other residential type environments and in catering and similar non-retail applications. It is not suitable for industrial or commercial use.
- **Intended purpose:** Do not use this appliance for anything other than its intended purpose, and only use it as described in this manual. Do not attempt to alter or modify this appliance in any way.
- **Usage restrictions:** The appliance can be used by children aged from 8 years and above, and persons with reduced physical, sensory or mental capabilities, or lack of experience and knowledge, if they have been given supervision or instruction concerning use of the appliance in a safe way and understand the hazards involved.

- **Children:** Supervise children to ensure they do not play with the appliance. Never allow children to operate, play with or crawl inside the appliance. Cleaning and user maintenance shall not be made by children unless they are aged from 8 years and above and supervised.
- **WARNING!** Do not use any **electrical appliances** (such as ice cream makers) inside refrigeration appliances, unless they are approved for this purpose by the manufacturer.

1.4 Cleaning and Maintenance

- **Disconnect:** Unplug the appliance before cleaning or servicing. Failure to do so can result in electric shock, injury or death. Do not connect or disconnect the plug when your hands are wet.
- **Flames:** Do not let open flames or ignition sources enter the appliance.
- **Flammable/explosive substances:** Never clean this appliance with flammable fluids. Do not store or use volatile, flammable or explosive propellants or liquids in or close to this or any other appliance. The fumes can create a fire hazard or explosion.
- **Solvents:** Do not use solvent-based cleaning agents or abrasives on the interior as these may damage or discolor the surfaces of the appliances.
- **WARNING!** Do not use **mechanical devices** or other means to accelerate the defrosting process. Never use a sharp or metal instrument to remove frost or clean the appliance. Use a plastic scraper, if necessary.
- **Service:** Do not attempt to repair, modify or replace any part of the appliance unless specifically recommended in this manual. Refer all other servicing to a qualified technician, or contact the after sales support line for advice on examination or repair of the appliance.

2. Product Overview

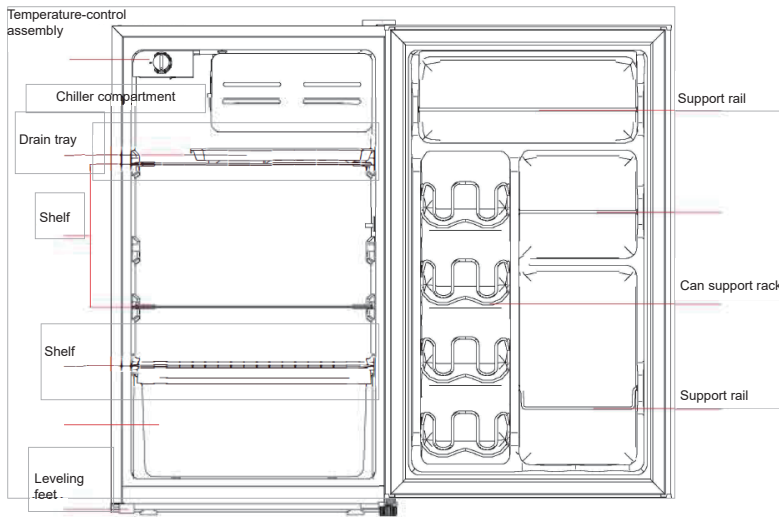

Temperature Control Dial

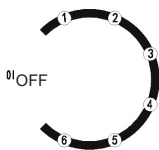

“OFF” will switch the cooling circuit off.

*The temperature of the fridge is adjusted through the thermostat knob (temperature-control assembly) referenced above. The numbers “1, 2, 3, 4, 5, 6” indicate the different levels of cooling and do not specifically relate to a preset temperature. Operating temperatures will vary depending on ambient temperature/ frequency of the door being opened. However, as a general guide, Position 1 will provide a temperature of approximately 11°C, position 3.5 is approximately 6°C and position 6 is approximately 2°C.

- The first time you turn the unit on, set the temperature control to the highest position (6). Then, after 24 hours, adjust the temperature control to the setting that suits your needs, position 4 or 5 should be appropriate for normal use.
- To turn the fridge off, turn the temperature control to the OFF position, then unplug the unit from power supply.

NOTES:

- The unit may not work at the set temperature on particularly hot days, or if the lid is opened too frequently.
- To ensure efficient operation, do not open the door unnecessarily or for prolonged periods of time.
- If the unit is unplugged, turned off or has lost power, you must wait 10 minutes before restarting the unit. If you attempt to restart before this time delay, the unit will not start.

3. Getting Started

3.1 Unpacking

- **Packaging materials:** This product has been packaged to protect it against transportation damage. Remove all packaging materials from around and inside the appliance and keep the original packaging carton and materials in a safe place. It will help prevent any damage if the product needs to be transported in the future, and you can use it to store the appliance when it is not in use. In the event that the carton is to be disposed of, please recycle all packaging materials where possible. Plastic wrapping can be a suffocation hazard for babies and young children, so ensure all packaging materials are out of their reach and disposed of safely.
- **Parts:** Check to ensure you have all the parts pictured opposite.
- **Power cord:** Unwind the power cord to its full length and inspect it for damage. Do not use the appliance if the appliance or its cord have been damaged or are not working properly. **In case of damage, contact our after sales support line for advice on examination, repair or return of the damaged product.**
- **Read the manual:** Before installing your new fridge read all safety instructions, especially the sections on installation and electrical safety. Then follow the installation instructions below and on the next page.
- **Clean:** Make sure the fridge is disconnected from the power supply before cleaning the interior surfaces and all internal accessories with lukewarm water, a soft cloth and a neutral/mild soap/detergent. This will remove any dust from transit and storage and help remove the typical smell of a brand new product. Then dry thoroughly. **Important:** Do not use harsh or abrasive detergents or powders as these will damage the finish.

3.2 Installation

3.2.1 Location

Install the appliance in an area that meets the following requirements:

- **Ambient temperature:** The ambient temperatures must correspond to the climate class (T) indicated on the rating plate of the appliance: 16°C - 43°C.
- **Floor surface:** The floor must be sturdy, level and strong enough to support the unit when it is fully loaded.
- **Areas to avoid:** Avoid areas where the appliance would be exposed to direct sunlight, sources of heat (stove, heater, radiator, etc.), extreme cold ambient temperatures or excessive moisture and high humidity. Installing it in the coolest area of the room will save energy consumption and running costs.

3.3 Reversing the Door Swing

This bar fridge can be opened from either side to suit your individual installation requirements. If you want to open the door from the other side, follow the instructions below and on the following pages to reverse the door swing.

Tools required: Phillips head screwdriver, flat-bladed screwdriver, hexagonal spanner (8mm)

Help required: We recommend you ask another person to help you during assembly.

- **WARNING!** Ensure the fridge is empty and disconnected from power supply.
- Keep all parts you remove for re-installation of the door on the other side.
- Tilt the appliance slightly towards the back and prop it up securely on something solid so that it will not slip during the door reversing process. Do not lay the unit flat as this may damage the coolant system.

Fig 1)

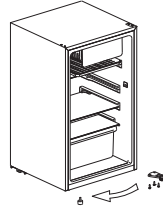
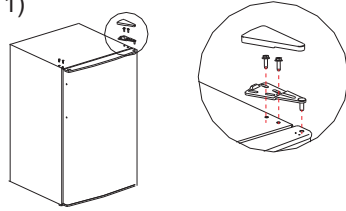

Fig 2)

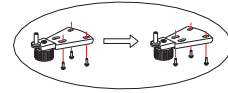
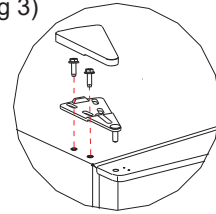
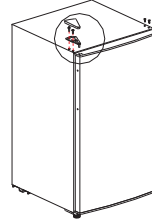

Fig 3)



- 1). Remove the upper hinge cover (plastic) by using a flat-blade screw driver to lever it off. Remove the upper hinge screws and lift off the metal hinge. Remove the plastic screw hole caps from the other side (Fig 1), again using a flat-blade screw driver to lever.
- 2). The door can then be removed (lift off the lower hinge support). Unscrew the bottom hinge assembly and leveling feet. Assemble the bottom hinge assembly and leveling feet on the opposite side.
- 3). Place the door on the bottom hinge and assemble the upper hinge, upper hinge cover and the plastic screw hole caps successively.

3.4 Adjustment of the Leveling Feet

To adjust the height of the front of the refrigerator, use the adjustable leveling feet:

- 1). Turn the feet clockwise to raise the front.
- 2). Turn the feet counter-clockwise to lower the fridge.
- 3). Adjust both feet until the fridge is stable and level.

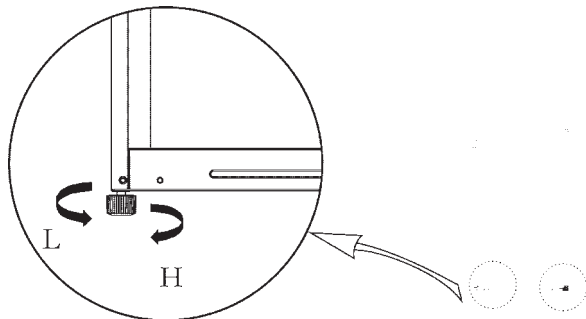

4. Product Use

4.1 Space Requirements

- **Clearances:** Ensure that air can circulate freely around the back of the cabinet, which is necessary to cool the compressor and condenser. Allow at least 10cm clear space at the back and 5cm at the sides of the unit.
- **Overhanging wall units:** Ideally, the appliance should not be positioned below overhanging wall units. However, if the appliance must be positioned below an overhanging wall unit, make sure to allow sufficient room so you can comfortably open the lid and access the contents.

4.2 Electrical Connection

- **WARNING!** It must be possible to disconnect the appliance from the mains power supply; the plug must therefore be easily accessible after installation.
- **Before plugging in your new fridge let it stand upright for at least 4 hours.** This will allow the refrigerant gases to settle into the compressor and reduce the possibility of a malfunction in the cooling system.
- **When first starting up, and after a period out of use, allow the unit to cool down on the highest setting (position 6) for at least 2 hours before placing food in the fridge.**
- The appliance must be earthed. The plug of the power supply cord is equipped with a contact for this purpose. Do not under any circumstances cut or remove the third (earth) prong from the power cord. If the plug does not fit your outlet, consult a licensed electrician for advice to have the outlet changed.
- Plug the unit into a dedicated, properly earthed wall outlet. Ensure that your outlet voltage and circuit frequency correspond to the voltage stated on the rating label.
- Secure the fridge's supply cord behind the unit. Do not leave it exposed or dangling to prevent injury and accidental disconnection from the power supply.
- Adjust the temperature control as described below.

4.3 Going Away?

- **Short vacation:** Leave the fridge operating during vacations of less than a month.
- **Long vacation:** If you are not going to use the fridge for longer periods, remove all food and unplug the power cord. Clean and dry the interior thoroughly. To prevent odor and mould growth, leave the lid open slightly, blocking it open, if necessary. (Restrict children's access to the room with the open fridge to avoid creating a child entrapment risk.)

4.4 Moving the Fridge

- Remove all food from inside the fridge, securely tape down the shelves and tape the door shut. Turn the leveling feet up to the base to avoid damage.
- Protect the outside of the unit with a blanket or similar soft material and make sure the fridge stays secure in the upright position during transportation.

4.5 Fresh Food Storage

- The refrigerator compartment is suitable for short-term storage of fresh food. The temperature inside varies depending on the amount of food stored and the frequency of door opening.
- In order to maintain good cooling efficiency and to save energy, we recommend you do not open the door for too long or too often. Do not overload the bar fridge, and keep enough space around items for cold air flow. Do not block ventilation openings.
- The glass shelves are adjustable to suit individual storage requirements.

4.6 Chiller Compartment

The chiller compartment is not a true freezer, but can be used for freezing small items such as ice cube trays and short term storage (3 - 4 days) of some frozen foods.

The temperature in this compartment does not get cold enough to freeze foods safely for long periods of time. It works best when the food is already frozen.

- Do not store bottled beverages in the chiller compartment as liquids may expand when frozen causing the bottle to break and potentially damage the appliance.
- The door of the chiller compartment is susceptible to breaking due to excessive ice build-up. This part is not covered under your warranty. Be sure to defrost when the ice reaches about 3 - 4mm in thickness.
- **Drip tray**
 - The drip tray is designed to catch melting ice during defrosting. It slides into the grooves underneath the chiller compartment. Empty any water out of the drip tray periodically. Then wash and dry it before placing it back.
- **Energy saving tips**
 - Place the fridge in the coolest area of the room, away from heat-producing appliances and out of direct sunlight.
 - Let hot foods cool to room temperature before placing them into the fridge. Overloading the fridge forces the compressor to run longer.
 - Wrap foods properly and wipe containers dry before placing them in the fridge. This cuts down on frost build-up inside the fridge.
 - Do not line any fridge storage bin with aluminum foil, wax paper or paper towels. Liners interfere with cold air circulation, reducing cooling efficiency.
 - Position food so that air can circulate freely around it.
 - Do not leave the fridge door open for longer than required.
- **Power Failure**
 - Most power failures are corrected within a few hours and should not affect the temperature inside your fridge, if you minimize the number of times the door is opened. However, if the power is going to be off for a longer period of time, you need to take proper steps to protect your food.

5. Troubleshooting

If you experience a problem with your bar fridge, check in the following table for solutions to help you solve the problem. If after these checks you still have a problem with your fridge, contact our after sales support line for advice.

CAUTION: Before troubleshooting, disconnect the power supply. Any troubleshooting that is not mentioned in this manual may only be carried out by a qualified electrician or similarly qualified person.

Problem	Possible cause
The fridge does not work.	<ul style="list-style-type: none"> • It is not plugged in. • The circuit breaker tripped or a blown fuse. • The thermostat knob is set to the minimum position.
The compressor turns on and off frequently. Does that indicate that there is a problem?	<ul style="list-style-type: none"> • The room temperature is hotter than normal. • A large amount of food has been added to the fridge. • The door is being opened too often. • The door is not closed completely. • The temperature control is not set correctly. • The door gasket does not seal properly. • The fridge does not have the correct clearances. <p>Note: It is normal for the compressor to switch on/off periodically this indicates that the set temperature is being regulated.</p>
The temperature inside the fridge is too warm.	<ul style="list-style-type: none"> • The temperature control is set too warm. Turn the control to a cooler setting and allow several hours for the temperature to stabilize. • The door is kept open too long or is opened too frequently. Warm air enters the fridge every time the door is opened. • The door is not closed completely. • A large amount of warm or hot food might have been stored recently. Wait until the fridge has had a chance to reach its selected temperature. • The fridge has recently been disconnected for a period of time. At least 2 hours are required for the fridge to cool down with the thermostat set to the highest position.
The fridge seems to make too much noise.	<ul style="list-style-type: none"> • The rattling noise may come from the flow of the refrigerant, which is normal. • As each cycle ends, you may hear gurgling sounds caused by the flow of refrigerant. • Contraction and expansion of the inside walls may cause popping and crackling noises.

<p>The door does not close properly.</p>	<ul style="list-style-type: none"> • The door was reversed and is not properly installed. • The gasket is dirty or bent. • The shelves, bins or baskets are out of position.
<p>The fridge door does not open.</p>	<ul style="list-style-type: none"> • The door has just been opened, leave it for a few minutes to allow the air pressure to equalize before trying again
<p>The external fridge surface is warm.</p>	<ul style="list-style-type: none"> • The exterior walls can be warm. This is normal while the compressor works to transfer heat from inside the fridge cabinet.
<p>There are vibrations; what is causing them? How can I stop the vibrations?</p>	<ul style="list-style-type: none"> • Check to ensure that the fridge is on a level surface. • The floor is uneven or weak. The fridge rocks on the floor when it is moved slightly. • The fridge is touching the wall. Re-level the fridge and move it away from the wall.
<p>Moisture forms on the inside or outside walls of the bar fridge</p>	<ul style="list-style-type: none"> • Hot and humid weather increases the internal rate of frost build-up. This is normal. • Open the door less often and make sure it is always properly closed.
<p>Excessive frost and ice has built up.</p>	<ul style="list-style-type: none"> • The fridge door has been left open. • Something is preventing the door from closing. • The door gasket is dirty or damaged.



6. Care and Cleaning

WARNING!

To reduce the risk of electric shock or injury, always switch off the appliance and disconnect it from the power supply before defrosting or cleaning it.

6.1 Defrosting the Bar Fridge

- For efficient operation and minimum energy consumption, defrost the bar fridge compartment when the frost on the chiller compartment walls is building up; do not let frost build up to more than 3 - 4mm thickness. Then follow the simple steps below.
- Turn the temperature control to the minimum position, unplug the fridge and remove the food. (Keep any food temporarily in a fridge or cooler bag to keep defrosting to a minimum.)
- During the defrost cycle, the ice melts into the drip tray. To remove the water, either take out the drip tray and/or place a collection container under the tray, or use a sponge or towel to wipe the melting ice off the fridge floor.
- Defrosting usually takes a few hours. After defrosting, wipe the drip tray and chiller compartment dry. Place the drip tray back under the chiller compartment and return the thermostat dial to the desired position.
- To defrost quickly, remove all foods from the fridge and leave the door open. Place an old towel underneath the appliance to collect any spillage.

WARNING!

- **Never use sharp or metallic tools to scrape off frost as it may damage the cooling system. To scrape ice off surfaces, use a plastic scraper.**
- **Do not use boiling water to accelerate defrosting because it may damage any plastic parts.**

6.2 Cleaning the Bar Fridge

- Turn the temperature control to the minimum position, unplug the bar fridge and remove the food, shelves and tray.
- Wash the inside surfaces and the interior accessories with a damp, warm cloth moistened in a water and baking soda solution (about 2 tablespoons of baking soda to 1 liter of water). Wring excess water out of the cloth before cleaning around the temperature control or any electrical parts. Rinse and wipe dry with a soft cloth.
- Clean the outside of the unit with a damp, well wrung out cloth. Keep the door gasket (seal) clean.
- After everything is dry, place the appliance back into service.

WARNING!

- Never clean the unit with an abrasive, acid, oil or solvent based cleaning agent, or with abrasive pads or scourers. Never use flammable fluids or sprays for cleaning as the fumes from these substances can create a fire hazard or explosion.
- Never clean the appliance with a steam cleaner. Moisture could accumulate in the electrical components, danger of electric shock! Hot vapors can lead to the damage of plastic parts.
- The appliance must be completely dry before it is placed back into service.



7. Technical Data

Rated voltage	220 - 240VAC
Rated frequency	50Hz
Rated current	0.8A
Climate class	T
Dimensions (mm)	860 (H) x 501 (W) x 540 (D)
Capacity	129L gross volume Note: Volume can be subject to manufacturing tolerance within 3%
Refrigerant	R600a, 22g
Insulation blowing agent	Cyclopentane
Net weight	24.5kg

8. Notice

8.1 Compliance

This appliance has been fully tested and meets all requirements as set out by standards AS/NZS 60335.1 and AS/NZS 60335.2.24.

8.2 Responsible Disposal

- At the end of its working life, do not throw this appliance out with your household rubbish. Electrical and electronic products contain substances that can have a detrimental effect on the environment and human health if disposed of inappropriately. Observe any local regulations regarding the disposal of electrical consumer goods and dispose of it appropriately for recycling and recovery of the refrigerant and blowing agent. Contact your municipal authorities for advice on recycling facilities in your area.
- This refrigeration appliance contains flammable refrigerants and insulation blowing gases, which must be removed before disposal. Contact your municipal authorities for any codes or regulations concerning the disposal of such materials.
- **DANGER! Risk of child entrapment:** When discarding the fridge, make sure to take off the lid so that children cannot easily climb in and get trapped inside.



LIVING & CO[®]

Warranty

We pride ourselves on producing a range of quality products that are both packed with features and completely reliable. We are so confident in our products, we back them up with a two years warranty. Now you too can relax knowing that you are covered.

Customer Helpline NZ: 0800 422 274
This product is covered by two years warranty
when accompanied by proof of purchase.

AFTER SALES SUPPORT
  0800 422 274